

Product information presented here reflects conditions at time of publication. Consult factory regarding discrepancies or inconsistencies.

## TECHNICAL DATA SHEET FLOOR SUCKER® SERIES Models 42, 44, 46 Utility Pumps

Use FLOOR SUCKER® Submerged or On Any Flat Surface to Pump Clear Water.

### PRODUCT SPECIFICATIONS

<b>MOTOR</b>	Horse Power	1/6 - 1/2
	Voltage	115
	Phase	1 Ph
	Hertz	60 Hz
	RPM	3450
	Type	Permanent split capacitor
	Insulation	Class B
	Amps	1.5 - 6.0
	<b>PUMP</b>	Operation
Discharge Size		Model 42: std garden hose adapter included, 1" NPT or 1-1/4" slip fit Model 44: std garden hose adapter included, 1-1/4" or 3/4" female NPT Model 46: 2" NPT w/ 2" hose adapter
Cord Length		9' (3 m) or 20' (6 m) standard
Cord Type		3-wire, grounded plug
Max. Head		33' (10 m)
Max. Flow Rate		3,300 GPH (12,492 LPH)
Max. Operating Temp.		104° F (40° C)
Cooling		Oil free (Models 42 & 44) or oil filled (Model 46)
Motor Protection		Auto reset thermal overload
Max. Submersion Depth		20' (6 m)
<b>MATERIALS</b>	Motor Housing	Engineered plastic
	Base	Engineered plastic
	Upper Bearing	Ball bearing
	Lower Bearing	Ball bearing
	Mechanical Seals	Carbon and ceramic
	Impeller Type	Non-clogging vortex
	Impeller	Engineered plastic
	Gasket	NBR

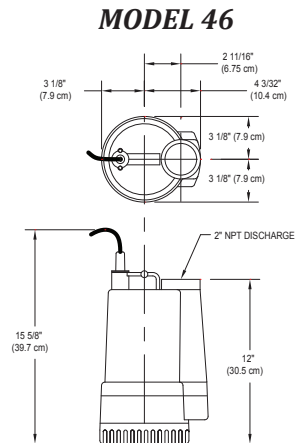
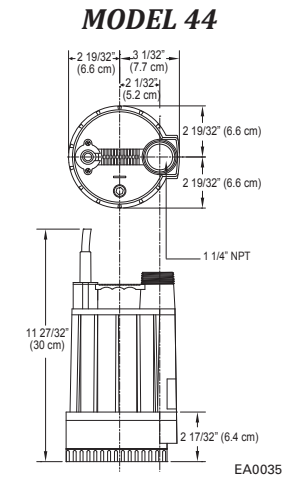
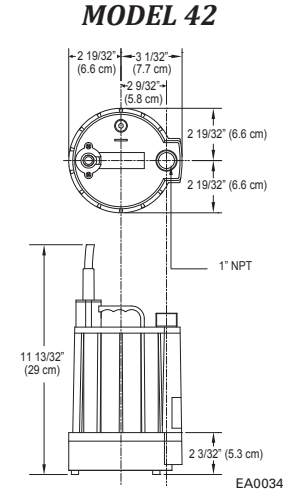

NOTE: See model comparison chart for specific details.

Models 42 & 44 fit into a 7" (178 mm) opening and removes water from flat surface within 1/8" (3.2 mm). Model 46 fits into an 8" (203 mm) and removes water to within 1" (52.4 mm)



**TOTAL DYNAMIC HEAD FLOW PER HOUR**

MODEL		42		44		46	
Feet	Meters	Gal.	Liters	Gal.	Liters	Gal.	Liters
5	1.5	900	3407	1800	6814	3300	12492
10	3.0	660	2498	1320	4997	2820	10675
15	4.6	360	1363	720	2725	2160	8176
20	6.1	--	--	--	--	1500	5678
30	9.1	--	--	--	--	300	1136
Shut-off Head:		19 ft. (5.8m)		20 ft. (6.1m)		34 ft. (10.4m)	

014066

\* Model LM44 not to be used as a sump pump

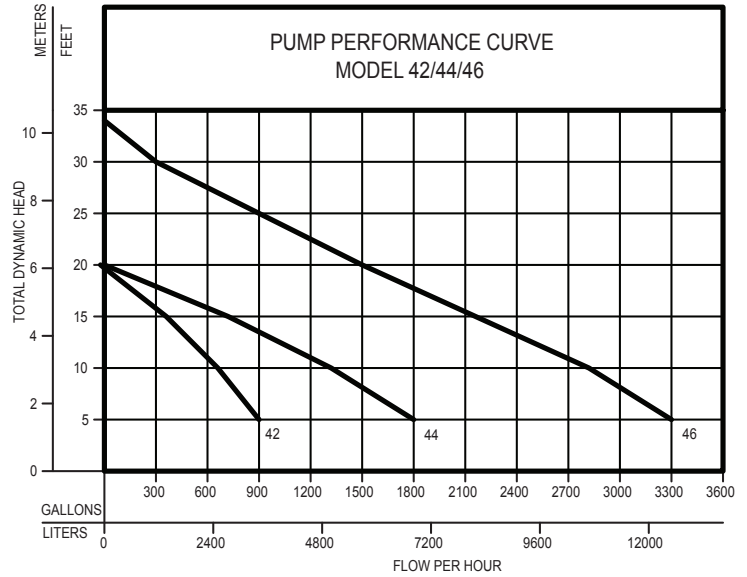

Model	MODEL COMPARISON										
	Seal	Mode	Volts	Ph	Amps	HP	Hz	Lbs	Kg	Max Width	Max Height
N42	Single	Non	115	1	1.5	1/6	60	7	3	6" (15 cm)	9-1/2" (24 cm)
LM44	Single	Auto	115	1	2.5	1/4	60	9	4	6" (15 cm)	11-3/4" (30 cm)
N44	Single	Non	115	1	2.5	1/4	60	9	4	6" (15 cm)	11-3/4" (30 cm)
N46	Single	Non	115	1	6.0	1/2	60	16	7	8" (20 cm)	14-1/2" (37 cm)